

# Dee J. Kelly Alumni & Visitors Center

## Room Capacities

### COX BANQUET ROOM

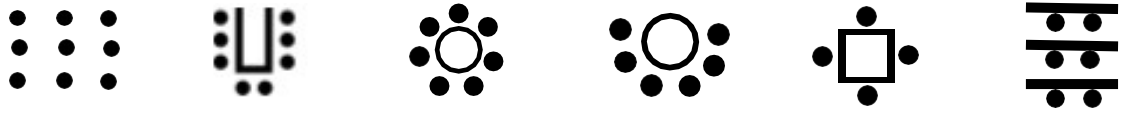

	Lecture	U-shape	Rounds 8 or 10 Chairs	Crescent Rounds 8 or 10 Chairs	Open Square	Workshop
<b>1 Banquet Room</b>	<b>125</b>	<b>34</b>	<b>72</b>	<b>54</b>	<b>44</b>	<b>45</b>
<b>2 Banquet Rooms</b>	<b>250</b>	<b>48</b>	<b>176</b>	<b>132</b>	<b>-</b>	<b>104</b>
<b>3 Banquet Rooms</b>	<b>450*</b>	<b>-</b>	<b>264/312</b>	<b>198/284</b>	<b>-</b>	<b>-</b>

\*The Kelly Center has 400 banquet chairs

	U-shape	Luncheon	Open Square	Conference	Workshop
<b>Boschini Conference Room</b>	<b>14</b>	<b>36</b>	<b>20</b>	<b>18</b>	<b>22</b>
<b>Murphy Conference Room</b>	<b>22</b>	<b>48</b>	<b>24</b>	<b>18</b>	<b>40</b>
<b>Parrish Conference Room</b>	<b>12</b>	<b>24</b>	<b>16</b>	<b>10</b>	<b>16</b>

**Tucker-Scully  
Conference Room**

**18** → **conference table**

**Kelly Conference Room**

**18** → **conference table and 10 additional lounge chairs**

**Scharbauer Library**

**6** → **living room setting- no AV**

**Justin Boardroom**

**65**

Lot 6  
Visitor  
Parking

# Dee J. Kelly Alumni & Visitors Center

## Floor Plan

2820 Stadium Dr.  
Fort Worth, TX 76129

Stadium Drive

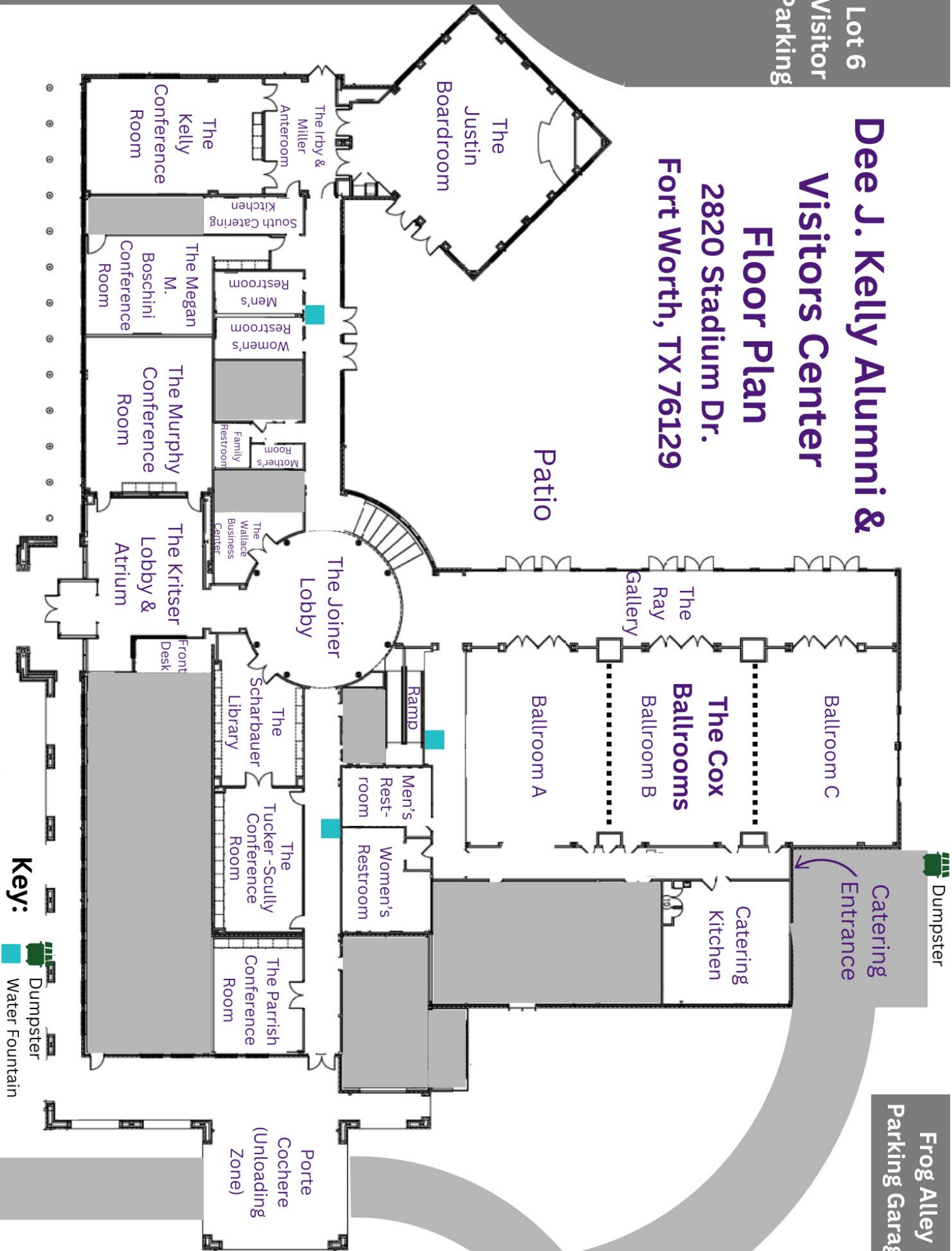

Frog Alley  
Parking Garage

# The Murphy Conference Room Setup Suggestions

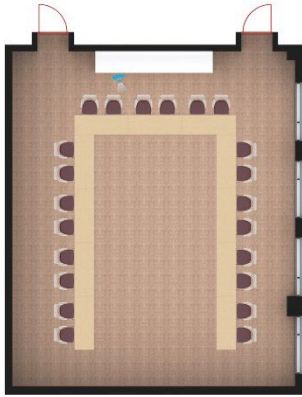

U-Shape – capacity 22

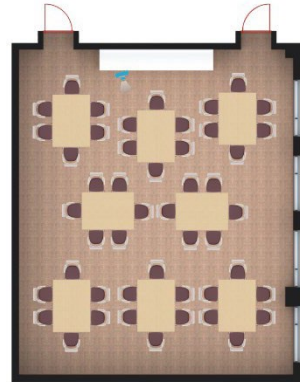

Luncheon – capacity 48

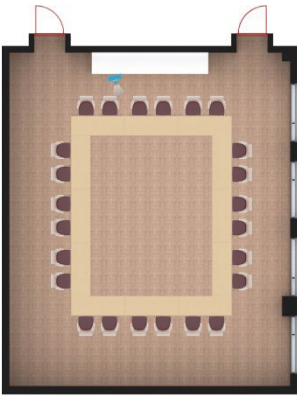

Open Square – capacity 24

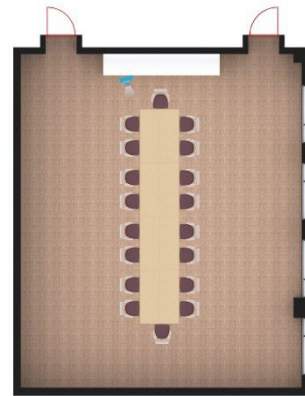

Conference – capacity 18

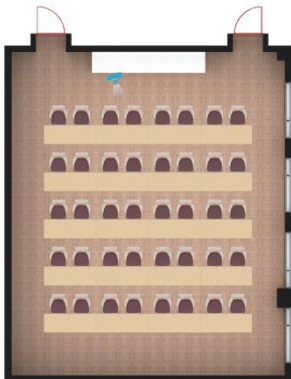

Workshop – capacity 40

## The Parrish Conference Room Setup Suggestions

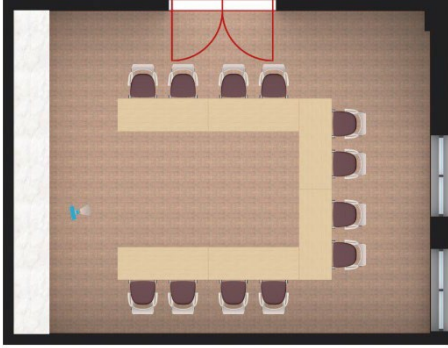

U-Shape – capacity 12

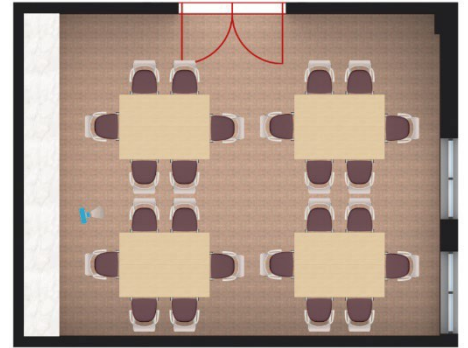

Luncheon – capacity 24

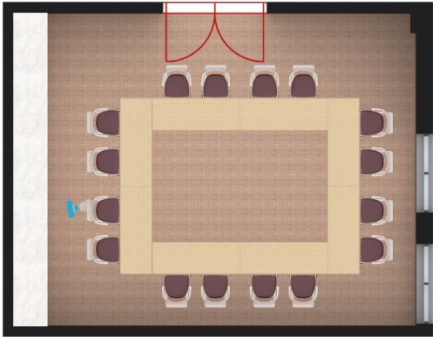

Open Square – capacity 16

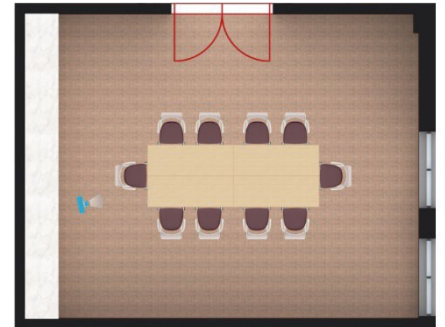

Conference – capacity 10

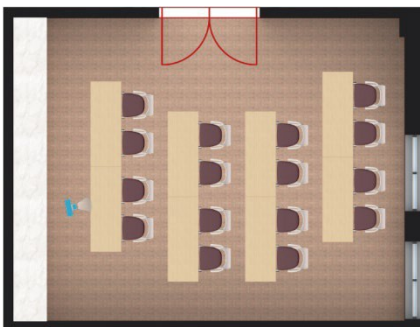

Workshop – capacity 16

# Megan M. Boschini Conference Room Setup Suggestions

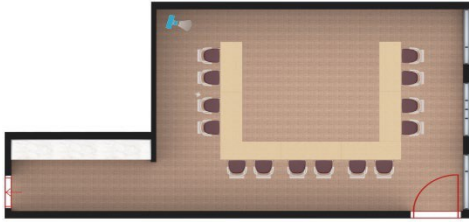

U-Shape – capacity 14

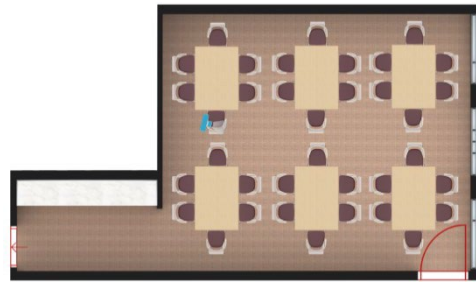

Luncheon – capacity 36

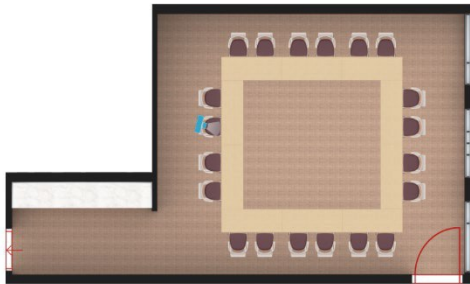

Open Square – capacity 20

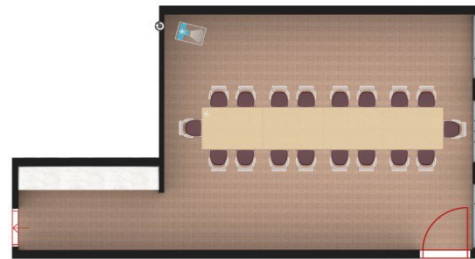

Conference – capacity 18

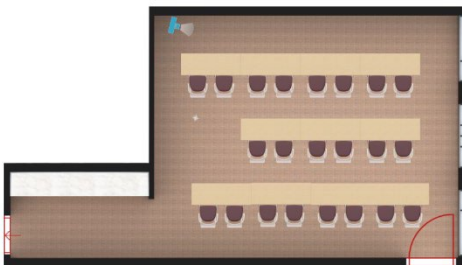

Workshop – capacity 22

## One Cox Banquet Room Setup Suggestions

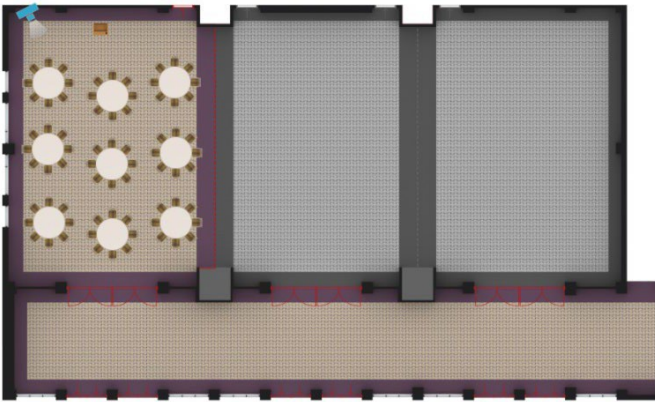

Rounds of 8 – Capacity: 72

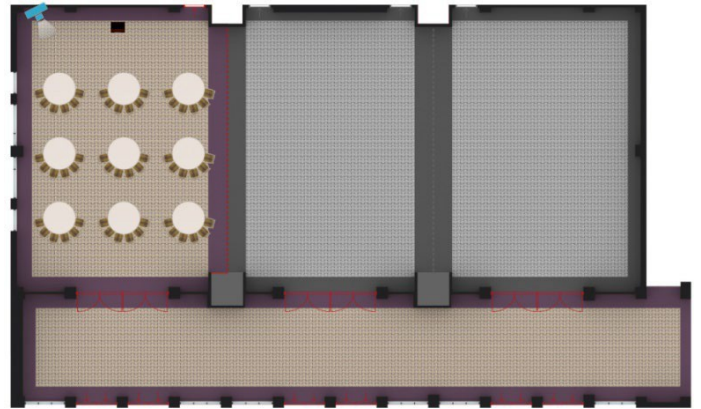

Speaker Circle – Capacity: 54

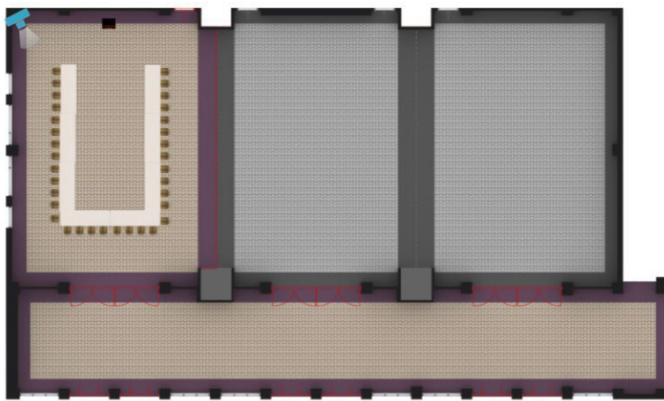

U-Shape – Capacity: 34

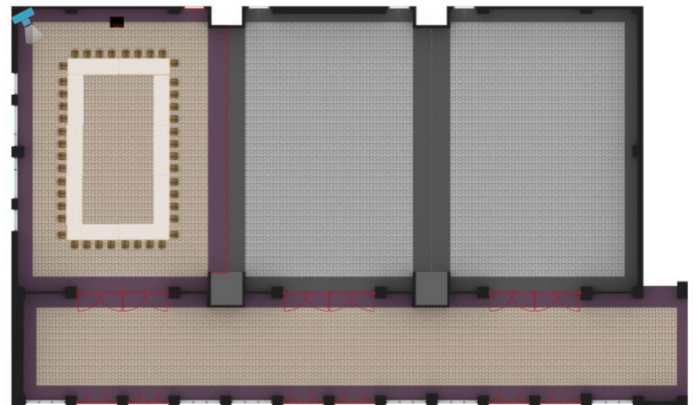

Open Square – Capacity: 44

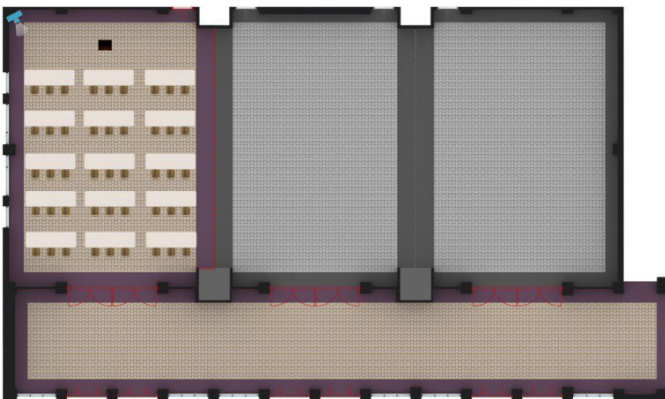

Workshop – Capacity: 45

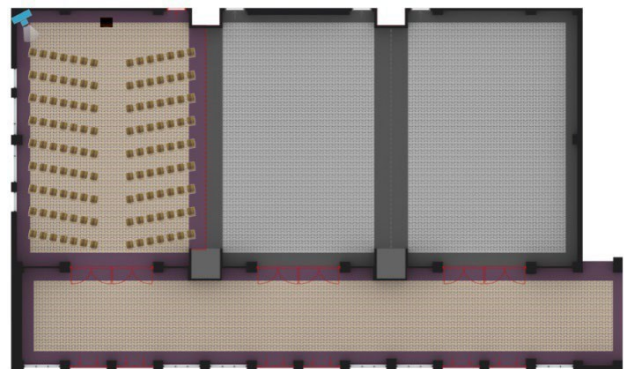

Lecture – Capacity: 125

## Two Cox Banquet Rooms Setup Suggestions

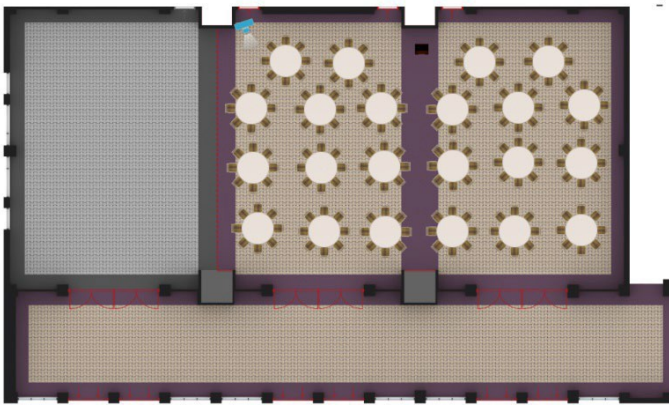

Rounds of 8 – Capacity: 176

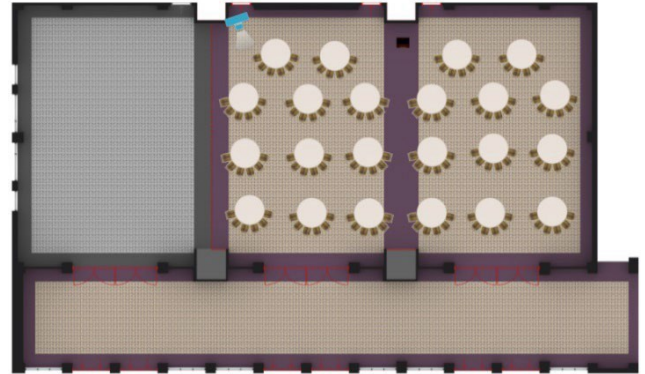

Speaker Circle – Capacity: 132

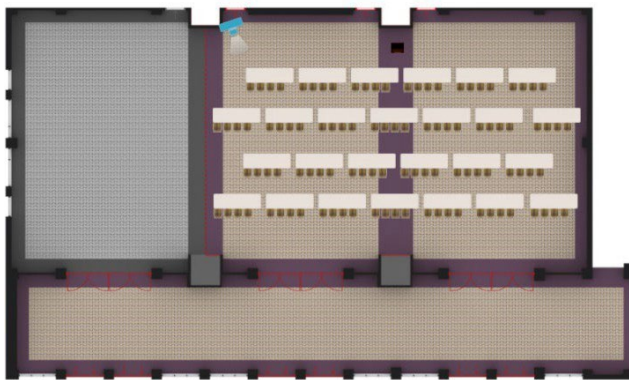

Workshop – Capacity: 104

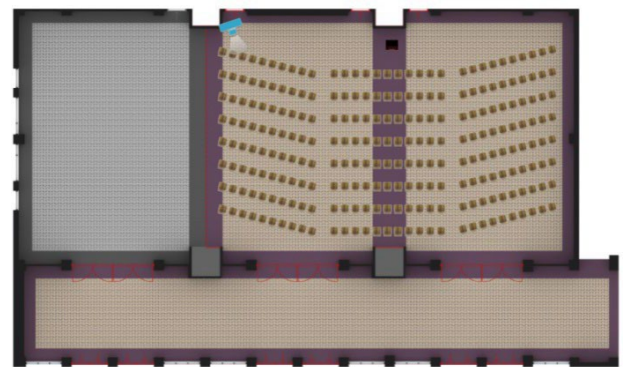

Lecture – Capacity: 250

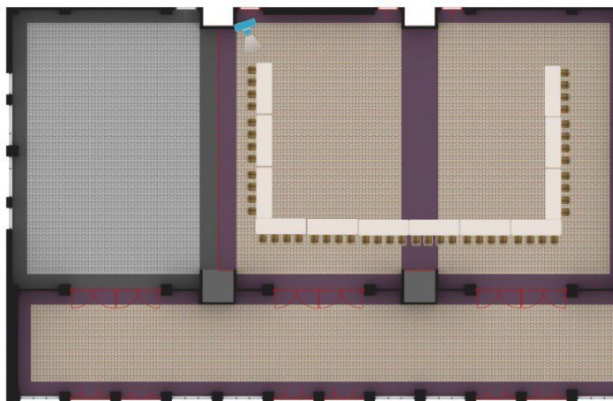

U-Shape Capacity: 48

# Cox A B & C Banquet Rooms Setup Suggestions

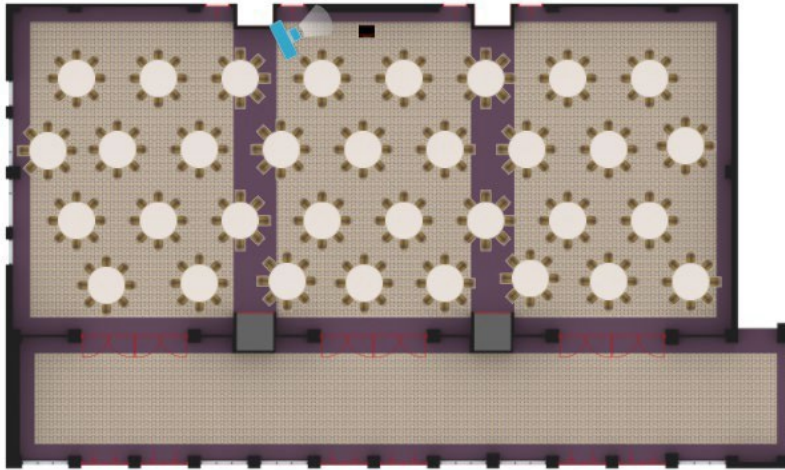

Rounds of 8 – Capacity: 264

Speaker Circle – Capacity: 198

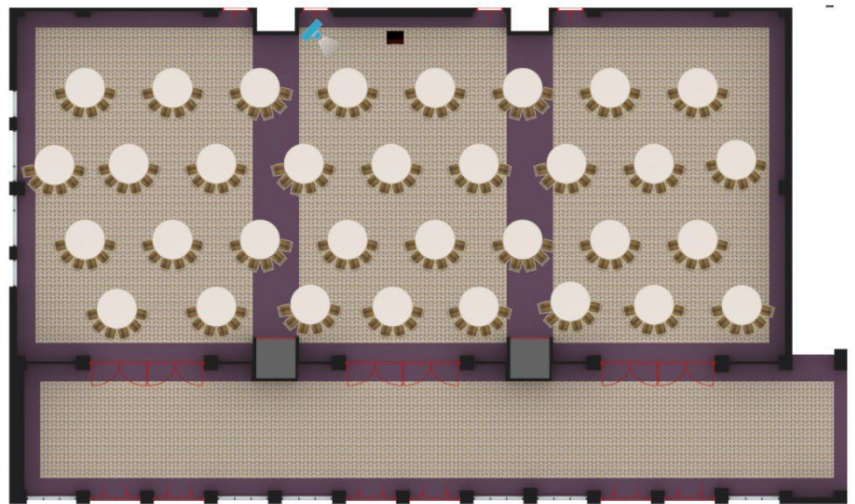

Lecture – Capacity: 400

